

# Universal Series Model 44B With Model 595E Power Unit Hydraulic Vibratory Driver/ Extractor



Highest frequency (1800 vpm) and driving force (207 tons, 1844 kN) in its class  
595HP (444 kW) CAT C15 Tier 3 (Stage IIIA) engine meets all  
EPA & EU emission regulations  
Up to 80 tons (712 kN) line pull for extraction

Computer controls on power unit reduce fuel consumption, pinpoint repair needs, & provide diagnostics and logs.

Optional 5,500 lbs (2494 kg) of bias weight increases pile penetration rates in difficult soils.

Maximum efficiency and reliability ensured by our open-loop hydraulic system. Highest quality, reliable piston pumps and motors.

Remote-control pendant for vibrator and clamp with emergency stop. Engine speed control for fuel efficiency.

Full range of clamps available for sheet piling, H-Beams, pipe & caissons and timber & concrete piles.

Adaptable for underwater, low headroom or box leads operation.

Heavy steel enclosure and fuel-tank subbase protect power unit.

Environmentally friendly, Chevron Clarity® non-toxic, biodegradable hydraulic oil.

Designed and manufactured in USA by ICE®, world leader in cost-effective foundation equipment since 1974.



©International Construction Equipment, Inc. All rights reserved. May 2010.

# Universal Series Model 44B With Model 595E Power Unit Hydraulic Vibratory Driver/ Extractor

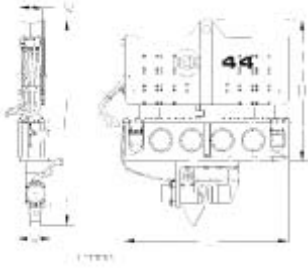

## Clamps & Accessories

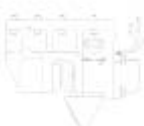

**Model 140C  
Sheeting  
Clamp**

Clamping force  
140 tons, 1245 kN  
Weight  
2,150 lbs., 975 kg



**Model 85  
Wood, Concrete  
& Pipe Clamp**

Clamping force  
85 tons, 756 kN  
Weight  
6,500 lbs., 2948 kg



**6.5' Caisson Beam with  
Model 100BH Caisson Clamps**

Clamping force  
220 tons, 1975 kN  
Weight  
3,200 lbs., 1451 kg

### Other Model 44B Accessories

12' Caisson beam      26' Leads sled  
10' Clamp extension      Low-headroom suppressor  
90° Turning plate      Vibrator stand  
Bias weights

## Model 44B Vibrator Specifications

Eccentric moment	4,400 in-lbs	51 kg-m
Frequency range	900,1800 vpm	
Driving force	207 tons	1844 kN
Centrifugal force	202 tons	1789 kN
Amplitude (free w/o clamp)	1.1 in	28 mm
Standard line pull for extracting	54 tons	483 kN
Maximum line pull for extracting	80 tons	725 kN
Weight (no clamp or hoses)	12,450 lbs	5647 kg
Non-vibrating weight	4,560 lbs	2068 kg
Height without clamp (H)	84 in	2134 mm
Length (L)	97 in	2464 mm
Width (W)	21 in	534 mm
Throat width (TW)	14.25 in	362 mm
Hydraulic hose length	150 ft	46 m
Hydraulic hose weight	1,425 lbs	646 kg
Height with sheeting clamp* (HH)	122 in	3096 mm
Weight with sheeting clamp & 1/2 hoses*	15,365 lbs	6970 kg
Height with beam & caisson clamps*	110 in	2784 mm
Weight with beam & caisson clamps*	16,235 lbs	7365 kg

\* See "Clamps and Accessories Manual" for detail description

## Model 595E Power Unit Specifications

Engine	Caterpillar C15	
Power	595 HP	444 kW
Operating speed	1,975 rpm	1975 rpm
Max. motors pressure	5,500 psi	380 bar
Motors flow (no load)	159 gpm	600 lpm
Clamp pressure	4,500 psi	310 bar
Clamp flow	6 gpm	21 lpm
Weight (w/ full fluid & 1/2 fuel)	16,350 lbs	7420 kg
Length	160 in	4040 mm
Width	73 in	1855 mm
Height	100 in	2540 mm
Hydraulic reservoir	430 gal	1630 liters
Fuel capacity	150 gal	570 liters

PACO Equipment | USA (WA/CA) - CANADA (Alberta / BC / Saskatchewan)

Corporate Office: 250 S. Webster Street Seattle, WA 98108 | 800.658.6379 | [pacoequip.com](http://pacoequip.com)